

CAIRO 90 D

FACILIDAD DE ACCESO A LA TURBINA DESDE LA CÁMARA DE COMBUSTIÓN.
EASE OF ACCESS TO THE TURBINE FROM THE COMBUSTION CHAMBER.
FACILIDADE DE ACESSO À TURBINA A PARTIR DA CÁMARA DE COMBUSTÃO.
FACILITÉ D'ACCÈS À LA TURBINE DEPUIS LA CHAMBRE DE COMBUSTION.
FACILITÀ DI ACCESSO ALLA TURBINA DALLA CAMERA DI COMBUSTIONE.



MODELO VERSÁTIL - MODELO VERSÁTIL - VERPATELJE MODEL - MODÈLLE POLYVALENT
ELIJA EL INTERIOR
CHOOSE THE INTERIOR
ESCOLHA O INTERIOR
CHOISISSEZ L'INTÉRIEUR
SCEGLI L'INTERNO

TOMA DE AIRE EXTERIOR - MODELO ESTANCO - OUTSIDE AIR INTAKE - HERMETIC MODEL - TOMADA DE AR EXTERIOR - MODELO ESTANQUE - PRESA D'ARIA ESTERIORE - MODELLO ERMETICO - PRISE D'AIR EXTERIEURE - MODELE ETANCHE



14 kW

79,5 %



4,2



350



kg



Kit Vermiculite: 170 Kit Ceramic: 180



4x120



780x254x416

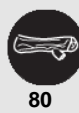

80

Features

- Double Combustion System
- Clean Glass System
- Heating power: 14kw
- Efficiency (%): 79,5%
- Consumption (kg/h): 4,2kg/h
- Heating capacity (m3): 350m3
- Manufactured in cast-iron and steel
- Weight (kg): Kit Vermiculite: 170kg Kit Ceramic: 185kg
- Smoke exit tube diameter (mm): 200mm
- Air channel (diameter and exit tube number): 4x120
- Useful chamber measures: 780x254x416mm
- Maximum logs size (cm): 80cm

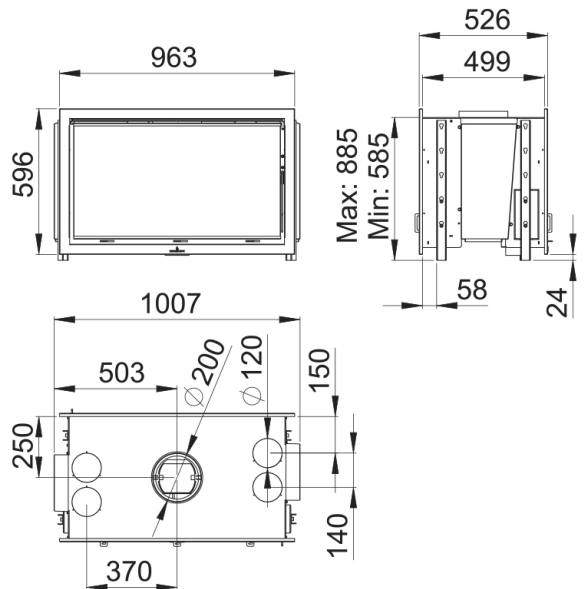

Given the continued improvement of our products and improving our manufacturing process, size, aesthetics and product specifications are subject to change without prior notice from our company.

www.bronpi.com



©Bronpi Calefacción, S.L. reserves all rights to the images that appear in this document. You may not reproduce or distribute part or all of the photographs and as the text. Both the brand as distinctive symbols are the exclusive property of the company. Violators will be prosecuted according to law.